

## RECESSED SLEEVE

*Hudson  
lighting*

CNC turned 6082-T6 aluminum, clear anodised. Suitable for all of Hudson Lighting's recessed light fittings.

20mm conduit couple can be used to connect to the rear of the sleeve.

Further extenders and mounts are available on request.

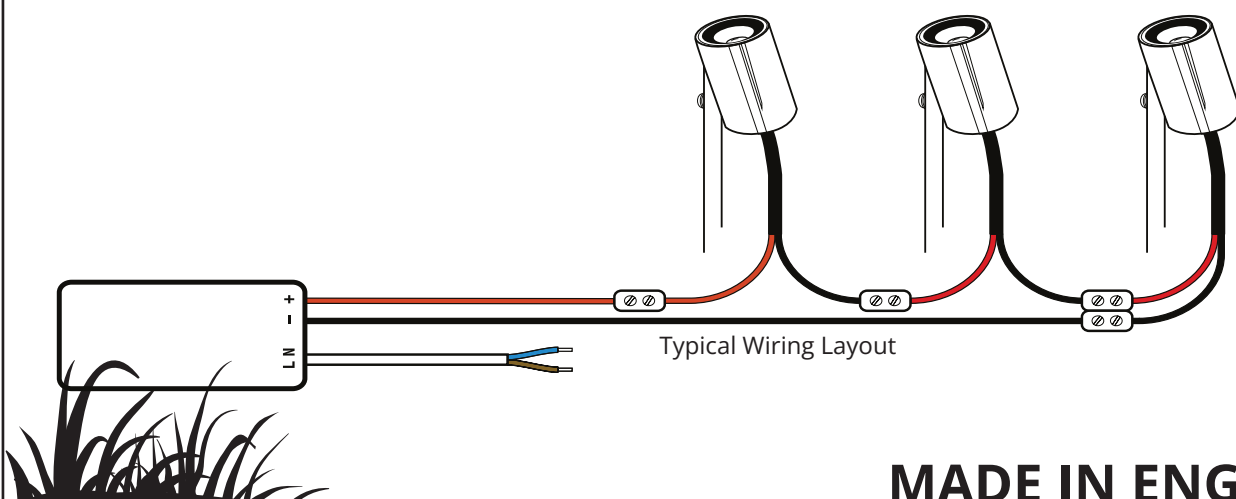
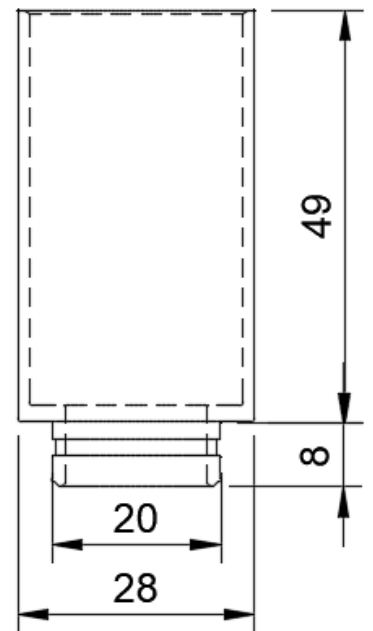

**MADE IN ENGLAND**

[hudsonlighting.co.uk](http://hudsonlighting.co.uk)